

0.5W AMORPHOUS SILICON SOLAR MODULE

ELECTRICAL CHARACTERISTICS

Cell Type	A-Si thin film solar module
Norminal Power	Pmax=0.5W
Open Circuit Voltage	Voc=6.3V
Short Circuit Current	Isc=160mA
Voltage at Pmax	Vm=4.2V
Current at Pmax	Im=120mA
Temp.Coefficient/Pm	-(0.19±0.03)%/°C
Temp.Coefficient/Vm	-(0.34±0.04)%/°C
Temp.Coefficient/Im	(0.08±0.02)%/°C

STANDARD TEST CONDITIONS(STC:1000W/m²,25°C,AM 1.5 SPECTRUM
TOLERANCE: ±10%

RELIABILITY STATISTICS

Operating Temperature Range	-40°C to +90°C
Humidity & Temperature Test	85°C & 85% humidity 1000h
Junction Box	IP65 rated
Outstanding performance under low light irradiance	

PERFORMANCE & IRRADIANCE CURVE

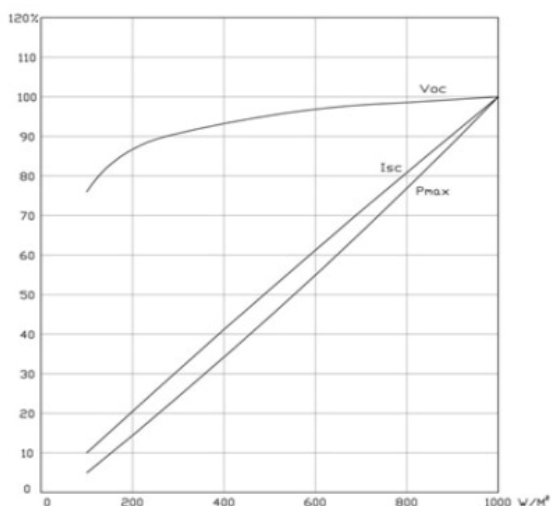

DIMENSIONS

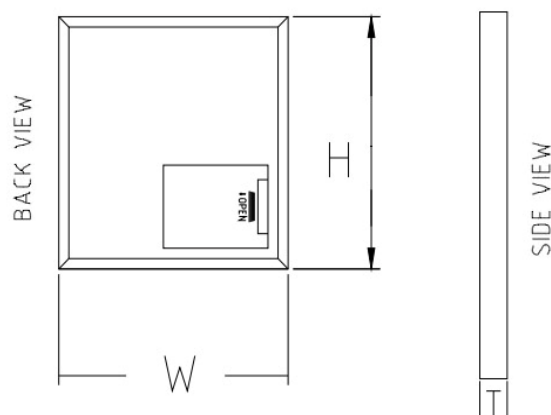

Item No: KS-A05W

H	W	T
121.5mm/4.8"	114mm/4.4"	16.7mm/0.7"

MICHANICAL SPECIFICATIONS

Dimensions(H*W*T) as above	121.5*114*16.7mm
Weight	0.3kg
Front Cover	TCO Glass
Back Cover	PET
Frame	Sliver anodized aluminum
Output Lead Wire	Waterproof wire

APPEARANCE SPECIFICATIONS

Delaminations or bubbles do not form a continuous path between any part of the electrical circuit and the edge of module
No any cracks, scratch or perforation in the glass or the backsheet

PROPERTY FOR SYSTEM DESIGN

Series Fuse Rating	0.5A
Maximum System Voltage	600V
Module Life	90% output for 10 years, 80% for 20 years
Recommended applications for Off-grid systems	

Design and specifications are subject to change without notice

Office Address:
N0.601,ZhongKang Pioneer Park,ZhongKang Road,
Futian District, ShenZhen City,Guangdong Province,China
Factory Address:
Longxi Hi-tech Industrial Park, Longcheng Road, Longgang
Town, ShenZhen City,Guangdong Province,China



Tel: +86.755.8351 5659
Fax: +86.755.8271 6024
Website: <http://www.solars-china.com>
Email: market@solars-china.com
MSN: market@solars-china.com
Skype: KAXIDY